



Fiat Punto (188)



### **DANGER**

**Airbag unit can trigger unintentionally!**

**Airbag unit is a pyrotechnic component that can lead to death on improper handling!**

**Only specially trained employees may carry out any work on the airbag system.**

**Disconnect the battery.**

**Always store airbag unit with the padded side pointing upward.**

**Always transport airbag unit in appropriate packaging.**

**Never leave airbag unit unattended, but lock safely in an appropriate cabinet.**

**Do not open or repair airbag unit.**

**Only install airbag unit in undamaged condition.**

**Do not perform any measurements on the airbag unit using a test lamp or multimeter.**

**Wear protective gloves and safety goggles.**

**No person may stay inside the vehicle when re-connecting the battery.**

### **NOTE**

**Ensure proper cleanliness when working on the servo-steering.**

**Steering column adjustment must remain locked during steering column removal.**

**Generally replace self-locking as well as corroded screws and nuts.**

**Repair work of any kind on the electromechanical steering column is not permissible, it must basically be completely replaced.**

**Observe disposal regulations!**

**Do not use oils, fats, chemicals and cleaners not approved by the manufacturer on airbag units.**

**The illustrations of these installation instructions are exemplary and are only intended for better understanding.**

## **Required special tools**

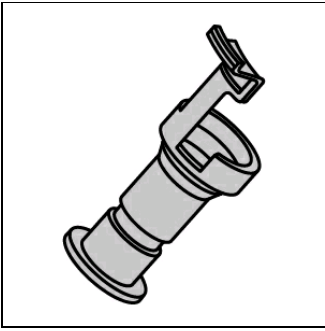

Steering column blocking tool  
OE (1870761000)

## **Required torques**

### **Tightening torques**

**Self-locking screws and nuts must always be replaced.**

Protective cover(s) screw(s) <b>(1)</b>	<b>(see figure 4)</b>	<b>Protective cover(s) 4,5 - 5,5 Nm; Electric motor 5 - 7 Nm</b>
Steering gear universal joint <b>(1)(2)</b>	<b>(see figure 5)</b>	<b>M8 33 Nm</b>
Steering column nut(s) <b>(1)</b>	<b>(see figure 6)</b>	<b>M8 15 Nm</b>
Steering wheel nut(s)		<b>M16x1,5 50 Nm</b>

## **Remove:**

**Move steering wheel to the centre position and let steering lock engage.**

**Disconnect battery (negative terminal).**

**Keep waiting time of min. 10 min.**

**Remove driver's airbag.**

Disconnect driver's airbag electric plug connection(s).  
Demount steering wheel.  
Remove fuse box cover in driver's footwell.

Unscrew and remove steering column shroud(s) lower screw(s). **(1)**  
Remove lower steering column shroud. **(2)**  
Unscrew and remove steering column shroud(s) upper screw(s). **(3)**  
Remove upper steering column shroud. **(4)**  
**(see figure 1)**

**Figure 1**

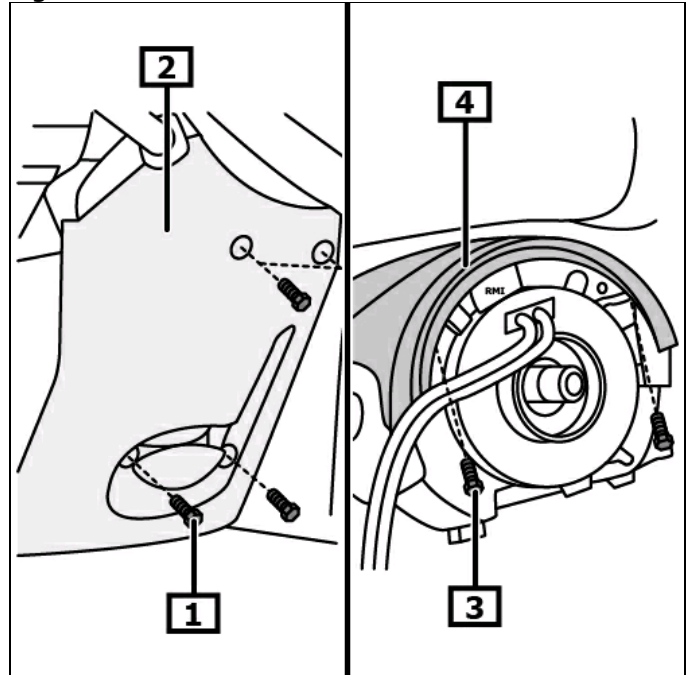

- |   |                                       |
|---|---------------------------------------|
| <b>1</b> Steering column shroud(s) lower screw(s) | <b>2</b> Lower steering column shroud |
| <b>3</b> Steering column shroud(s) upper screw(s) | <b>4</b> Upper steering column shroud |

## **For vehicles with ESP**

Loosen contact unit electric plug connection. **(1)**  
Unscrew contact unit screw(s). **(2)**  
**Do not twist contact unit.**  
Remove contact unit. **(3)**  
Disconnect steering column module electric plug connection(s). **(4)**  
Unscrew and remove steering column module screw(s). **(5)**  
Remove steering column module incl. steering-column switch. **(6)**

## **Vehicles without ESP**

Disconnect steering column module electric plug connection(s). **(4)**  
Unscrew and remove steering column module screw(s). **(5)**  
Remove steering column module incl. steering-column switch. **(6)**  
**(see figure 2)**

**Figure 2**

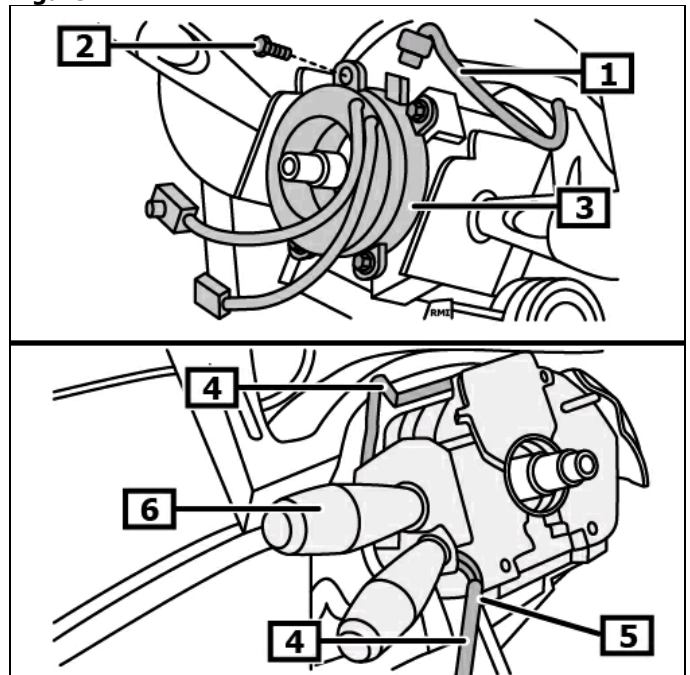

- |  |                                   |
|--|-----------------------------------|
| <b>1</b> Electrical connection(s)        | <b>2</b> Contact unit screw(s)    |
| <b>3</b> Contact unit                    | <b>4</b> Electrical connection(s) |
| <b>5</b> Steering column module screw(s) | <b>6</b> Steering column module   |

Install steering column blocking tool. **(1)**

**Required special tools**

Steering column blocking tool **OE (1870761000)**

**(see figure 3)**

Disconnect ignition lock electric plug connection(s).

**Figure 3**

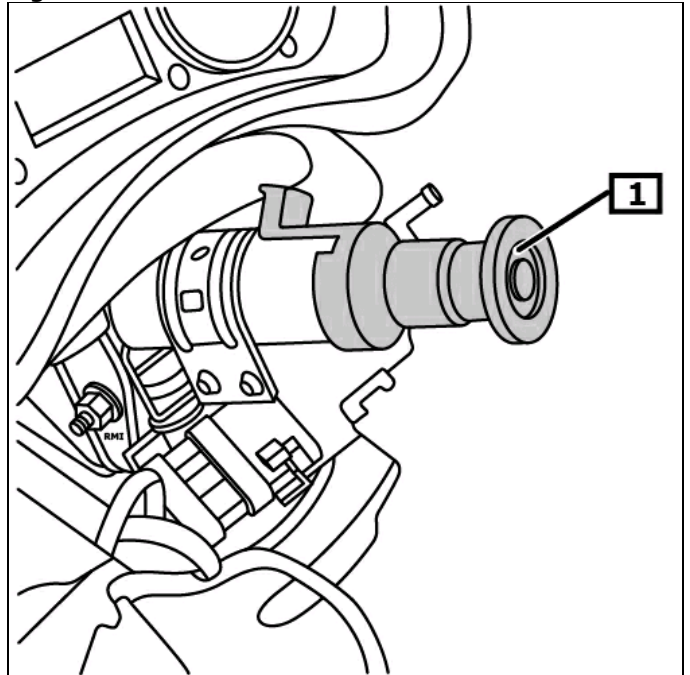

**1 Steering column blocking tool**

Unscrew and remove protective cover(s) screw(s). **(1)**

Remove protective cover(s). **(2)**

**(see figure 4)**

Disconnect steering column electric plug connection(s).

**Figure 4**

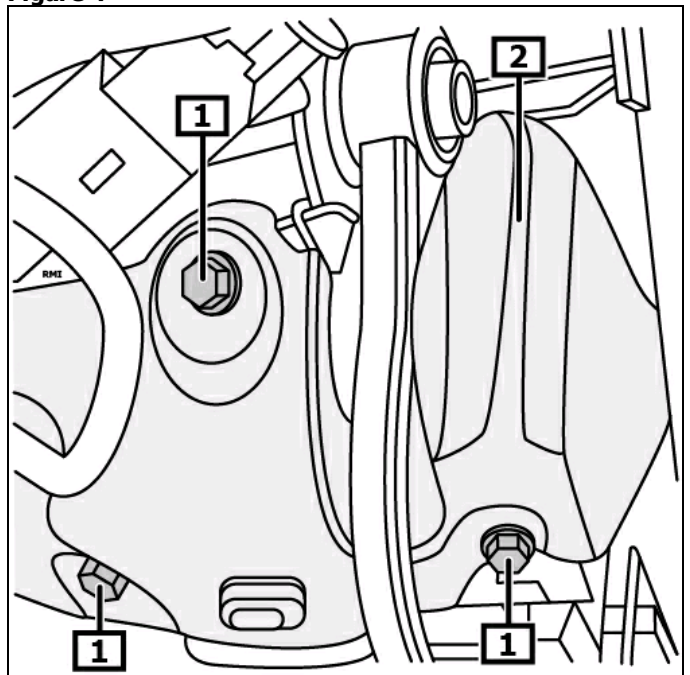

**1 Protective cover(s) screw(s)**

**2 Protective cover(s)**

### Vehicles of to 2003/05

Unscrew universal joint bolt(s). **(1)**  
Remove the universal joint upward from the steering gear. **(4)**

### Vehicles from 2003/06

Unscrew the universal joint nut(s). **(2)**  
Remove counter support. **(3)**  
Remove the universal joint upward from the steering gear. **(4)**  
**(see figure 5)**

Figure 5

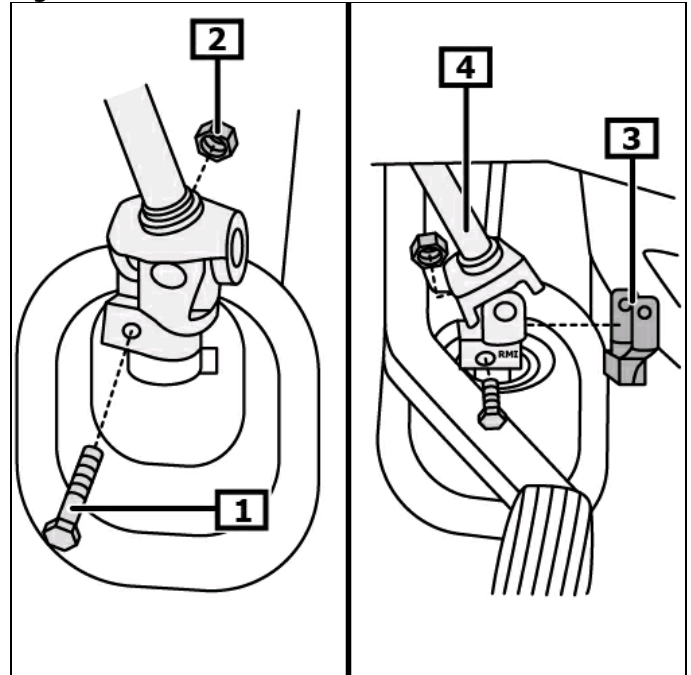

1 Universal joint bolt(s)

2 Universal joint nut(s)

3 Counter support

4 Steering gear universal joint

Unscrew and remove steering column nut(s). **(1)**  
Remove the steering column. **(2)**  
**(see figure 6)**

Convert following components when replacing the steering column:

- Ignition lock
- Intermediate steering shaft
- Electric motor for power steering
- Electric power steering control unit

### Install:

**Installation in reverse order of removal.**

Remove steering column blocking tool. **(1)**

### Required special tools

Steering column blocking tool **OE (1870761000)**

**(see figure 3)**

Code radio and reprogram vehicle settings if required.  
Check electrical system for function.

### Teach the steering angle sensor.

Teach steering angle sensor using appropriate diagnostic unit.

**Note position of EOBD connection.**

Figure 6

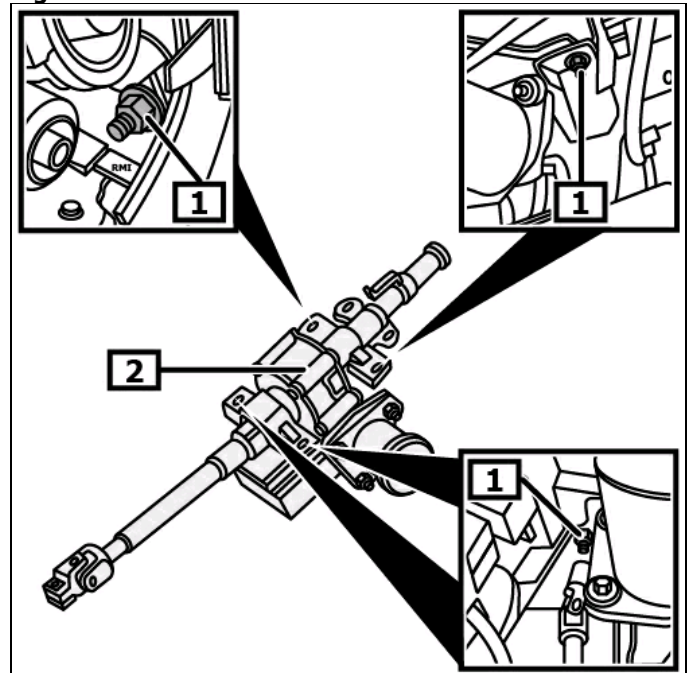

1 Steering column nut(s)

2 Steering column