



Fiat Punto (188)



DANGER

Airbag unit can trigger unintentionally!

Airbag unit is a pyrotechnic component that can lead to death on improper handling!

Only specially trained employees may carry out any work on the airbag system.

Disconnect the battery.

Always store airbag unit with the padded side pointing upward.

Always transport airbag unit in appropriate packaging.

Never leave airbag unit unattended, but lock safely in an appropriate cabinet.

Do not open or repair airbag unit.

Only install airbag unit in undamaged condition.

Do not perform any measurements on the airbag unit using a test lamp or multimeter.

Wear protective gloves and safety goggles.

No person may stay inside the vehicle when re-connecting the battery.

NOTE

Ensure proper cleanliness when working on the servo-steering.

Steering column adjustment must remain locked during steering column removal.

Generally replace self-locking as well as corroded screws and nuts.

Repair work of any kind on the electromechanical steering column is not permissible, it must basically be completely replaced.

Observe disposal regulations!

Do not use oils, fats, chemicals and cleaners not approved by the manufacturer on airbag units.

The illustrations of these installation instructions are exemplary and are only intended for better understanding.

Required special tools

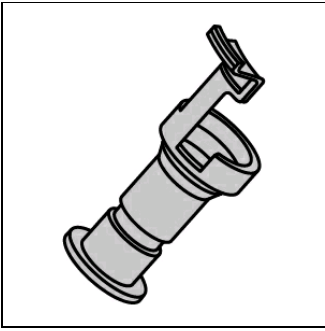

Steering column blocking tool
OE (1870761000)

Required torques

Tightening torques

Self-locking screws and nuts must always be replaced.

Protective cover(s) screw(s) (1)	(see figure 4)	Protective cover(s) 4,5 - 5,5 Nm; Electric motor 5 - 7 Nm
Steering gear universal joint (1)(2)	(see figure 5)	M8 33 Nm
Steering column nut(s) (1)	(see figure 6)	M8 15 Nm
Steering wheel nut(s)		M16x1,5 50 Nm

Remove:

Move steering wheel to the centre position and let steering lock engage.

Disconnect battery (negative terminal).

Keep waiting time of min. 10 min.

Remove driver's airbag.

Disconnect driver's airbag electric plug connection(s).
Demount steering wheel.
Remove fuse box cover in driver's footwell.

Unscrew and remove steering column shroud(s) lower screw(s). **(1)**
Remove lower steering column shroud. **(2)**
Unscrew and remove steering column shroud(s) upper screw(s). **(3)**
Remove upper steering column shroud. **(4)**
(see figure 1)

Figure 1

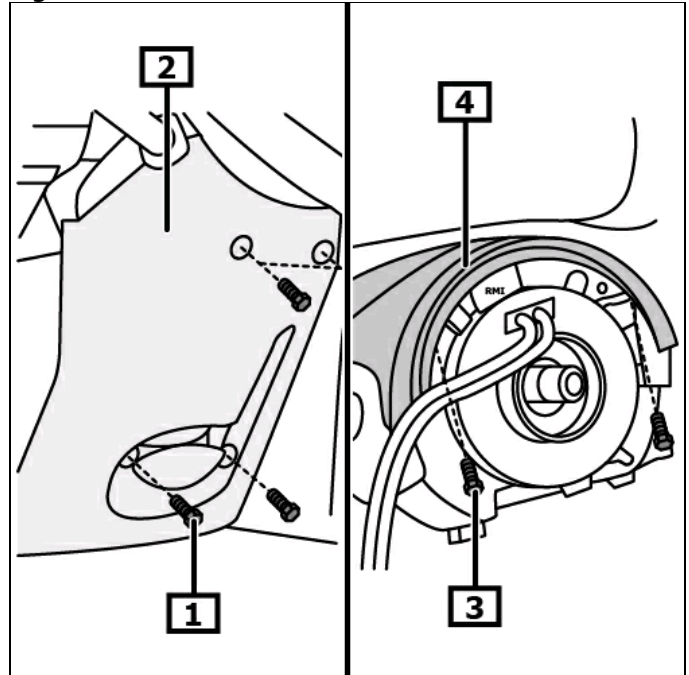

- | | |
|---|--|
| 1 Steering column shroud(s) lower screw(s) | 2 Lower steering column shroud screw(s) |
| 3 Steering column shroud(s) upper screw(s) | 4 Upper steering column shroud screw(s) |

Vehicles with ESP

Loosen contact unit electric plug connection. **(1)**
Unscrew contact unit screw(s). **(2)**
Do not twist contact unit.
Remove contact unit. **(3)**
Disconnect steering column module electric plug connection(s). **(4)**
Unscrew and remove steering column module screw(s). **(5)**
Remove steering column module incl. steering-column switch. **(6)**

Vehicles without ESP

Disconnect steering column module electric plug connection(s). **(4)**
Unscrew and remove steering column module screw(s). **(5)**
Remove steering column module incl. steering-column switch. **(6)**
(see figure 2)

Figure 2

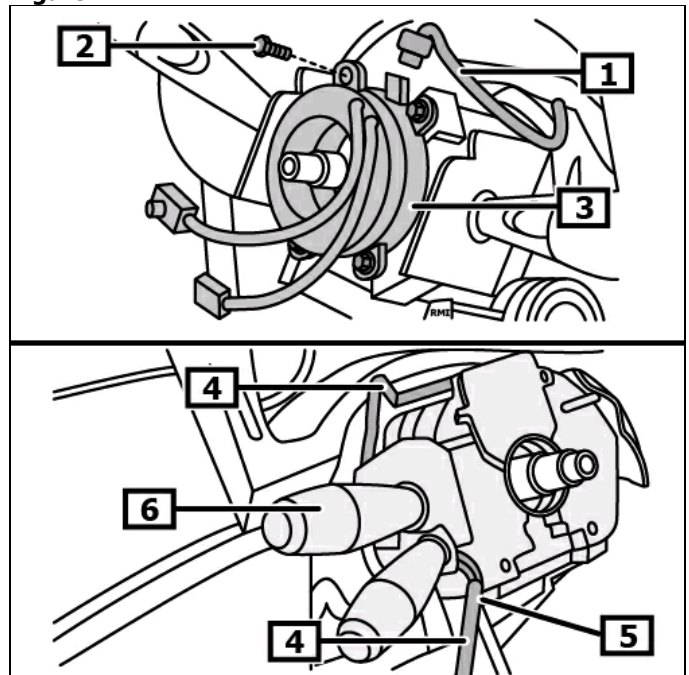

- | | |
|--|-----------------------------------|
| 1 Electrical connection(s) | 2 Contact unit screw(s) |
| 3 Contact unit | 4 Electrical connection(s) |
| 5 Steering column module screw(s) | 6 Steering column module |

Install steering column blocking tool. **(1)**

Required special tools

Steering column blocking tool **OE (1870761000)**

(see figure 3)

Disconnect ignition lock electric plug connection(s).

Figure 3

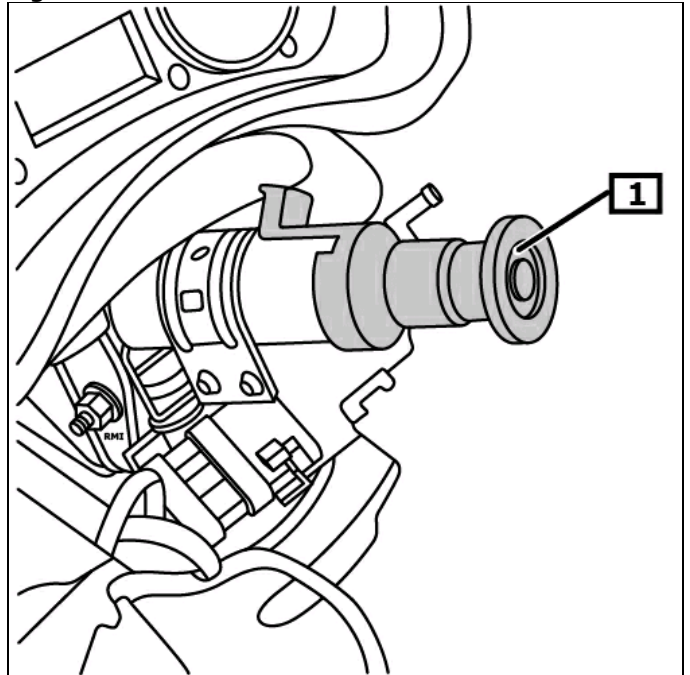

1 Steering column blocking tool

Unscrew and remove protective cover(s) screw(s). **(1)**

Remove protective cover(s). **(2)**

(see figure 4)

Disconnect steering column electric plug connection(s).

Figure 4

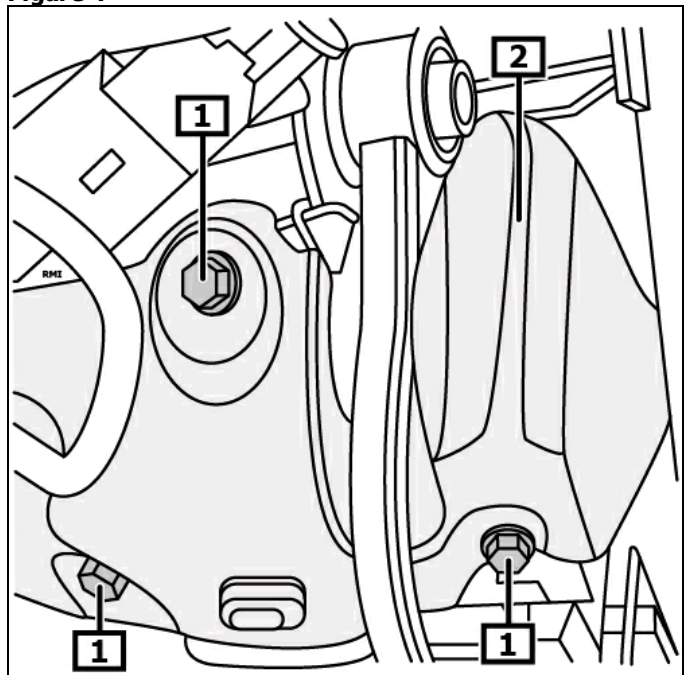

1 Protective cover(s) screw(s)

2 Protective cover(s)

Vehicles of to 2003/05

Unscrew universal joint bolt(s). **(1)**
Remove the universal joint upward from the steering gear. **(4)**

Vehicles from 2003/06

Unscrew the universal joint nut(s). **(2)**
Remove counter support. **(3)**
Remove the universal joint upward from the steering gear. **(4)**
(see figure 5)

Figure 5

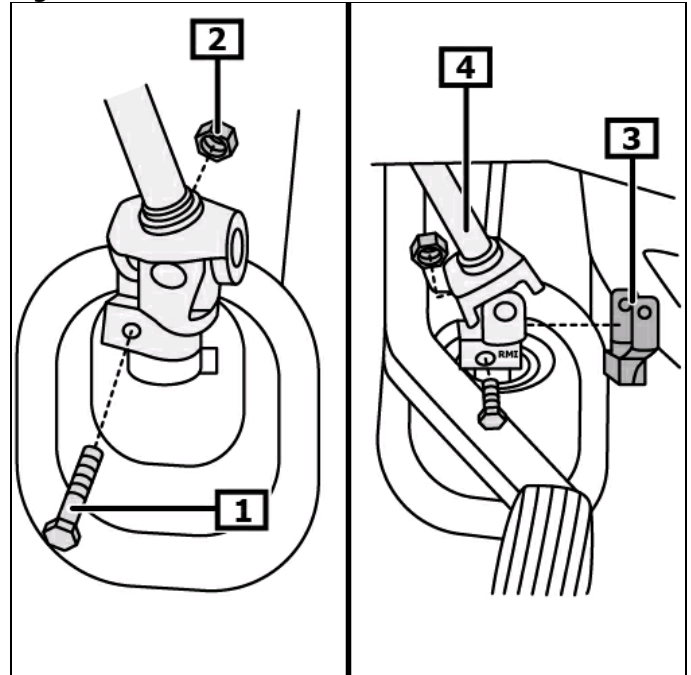

1 Universal joint bolt(s)

2 Universal joint nut(s)

3 Counter support

4 Steering gear universal joint

Steering column tilt adjustment must be locked!

Unscrew and remove steering column nut(s). **(1)**
Remove the steering column. **(2)**
(see figure 6)

Convert following components when replacing the steering column:

- Ignition lock
- Intermediate steering shaft
- Electric motor for power steering
- Electric power steering control unit

Install:

Installation in reverse order of removal.

Remove steering column blocking tool. **(1)**

Required special tools

Steering column blocking tool **OE (1870761000)**

(see figure 3)

Code radio and reprogram vehicle settings if required.
Check electrical system for function.

Teach the steering angle sensor.

Teach steering angle sensor using appropriate diagnostic unit.

Note position of EOBD connection.

Figure 6

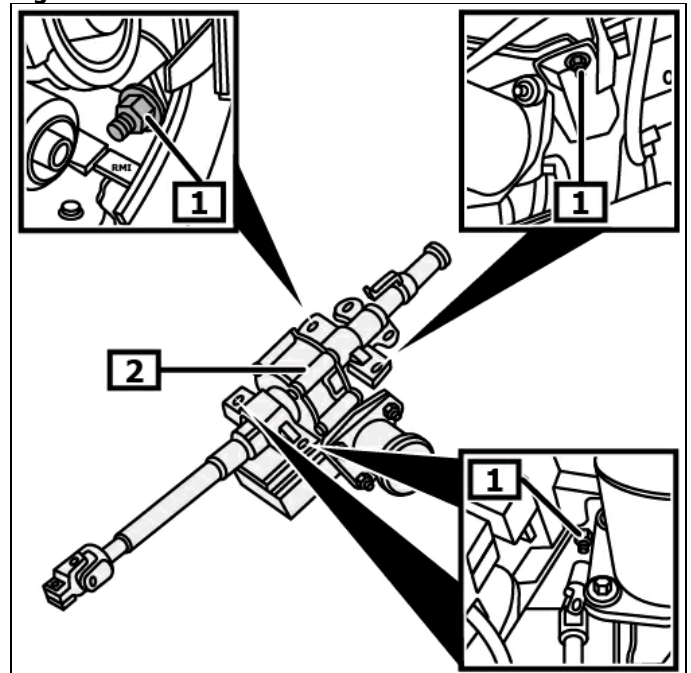

1 Steering column nut(s)

2 Steering column