



DAF / IVECO / MAN / Renault

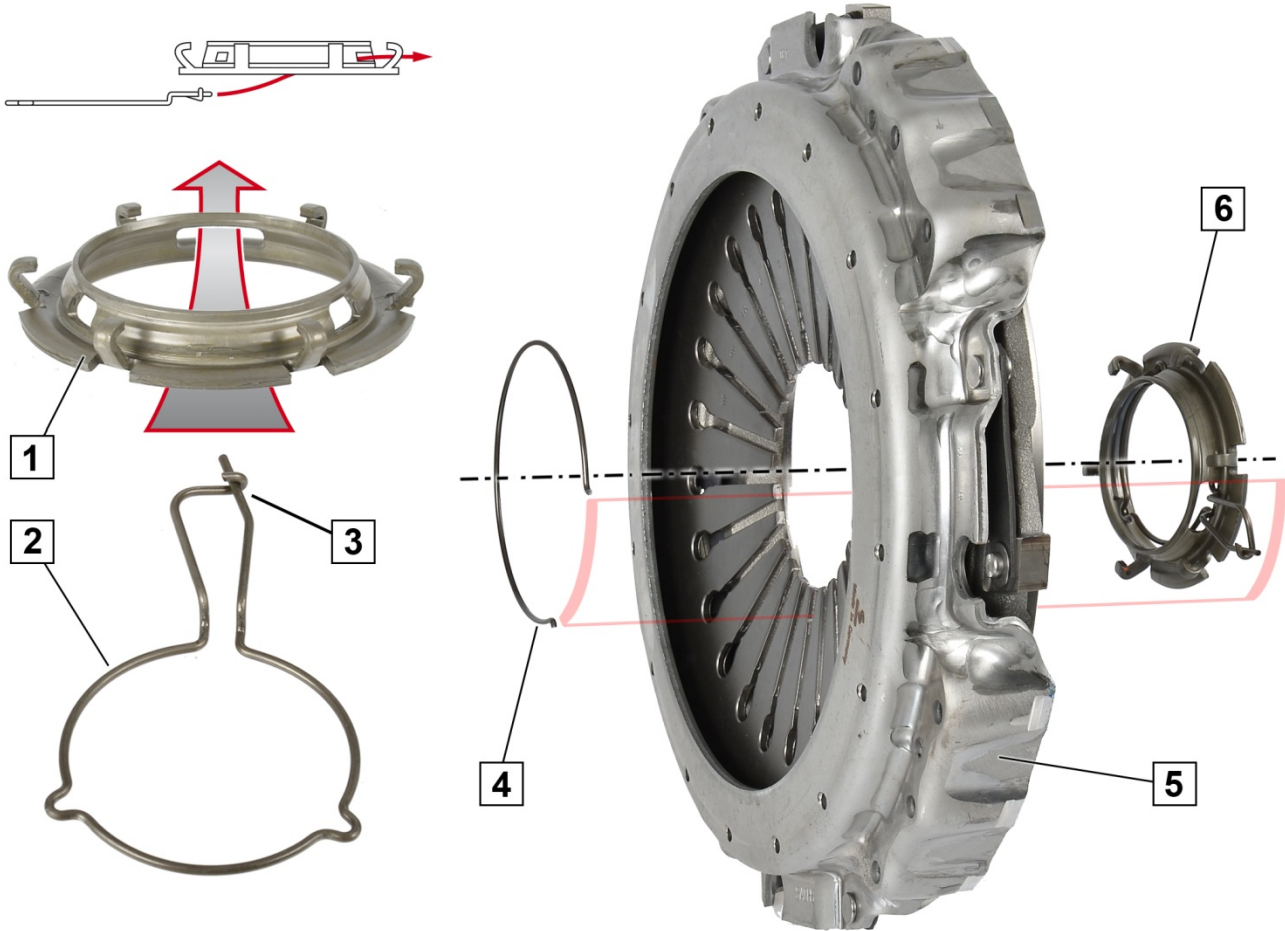

Fig. 1: Assembly of release ring and load ring

Fig. 2: Clutch cover assembly

- 1 Release ring
- 2 Load ring
- 3 Load ring lock
- 5 Clutch cover with diaphragm spring

- 4 Clamping ring
- 6 Release ring with load ring

CAUTION

Danger of pinching.
Lift clutch cover with suitable lifting device.

Pay attention to correct assembly sequence and component alignment.

1. Connect release ring (1) to load ring (2) (Fig.1) → release ring with load ring (6).
2. Position the release ring with the load ring (6) into the wider notches of the diaphragm spring tips and clip into the clamping ring (4). Position the clamping ring (4) so that the load ring lock (3) lies in the notches of the clamping ring (4) (Fig. 2; red markings).



SCANIA

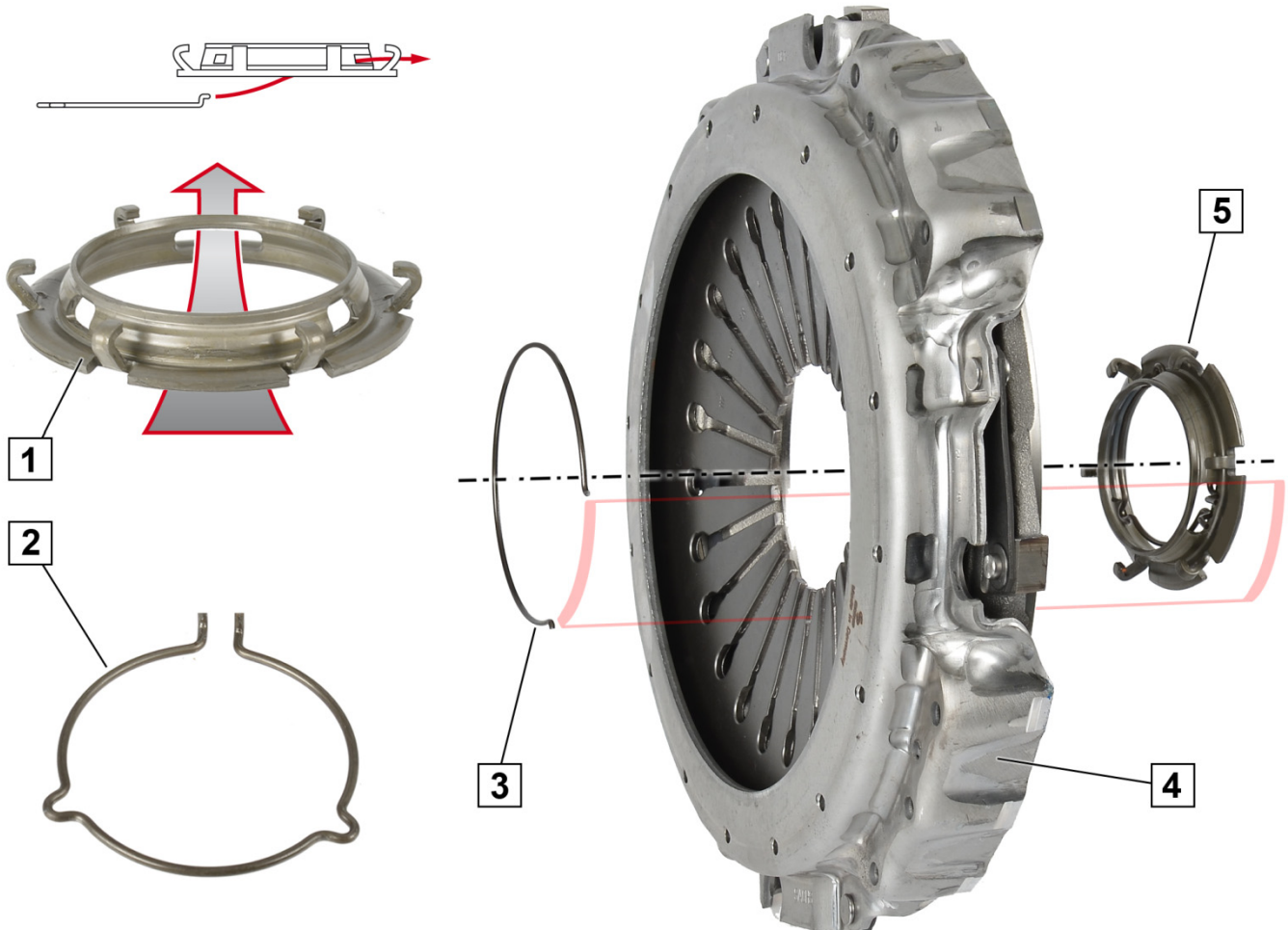

Fig. 3: Assembly of release ring and load ring

Fig. 1: Clutch cover assembly

- | | | | |
|---|-----------------------------|---|------------------------------------|
| 1 | Release ring | 2 | Load ring |
| 3 | Clamping ring | 4 | Clutch cover with diaphragm spring |
| 5 | Release ring with load ring | | |

CAUTION

Danger of pinching.
Lift clutch cover with suitable lifting device.

Pay attention to correct assembly sequence and component alignment.

1. Connect release ring (1) to load ring (2) (Fig.1) → release ring with load ring (5).
2. Position the release ring with the load ring (5) into the wider notches of the diaphragm spring tips and clip into the clamping ring (3). Position the clamping ring (3) in such a way that the open end of the load ring (2) is in the recess of the clamping ring (3) (Fig. 2, marked in red).



www.aftermarket.zf.com/serviceinformation